

USER MANUAL



Thank you for choosing Better Bathrooms.
Please read this manual before installing your product
and keep for future reference.

better
bathrooms

Product name — Douche Kit with Thermostatic Valve
Product code — TDKCH/TKBB/TKMB

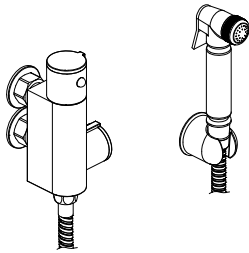

IMPORTANT

1. We recommend that this product is installed by a qualified professional contractor, such as a plumber who is certified by NVQ (National Vocational Qualification) or SNVQ (Scottish National Vocational Qualification) Level 3
2. Please check this product immediately to ensure that it has not been damaged and is complete. Before installation, please make sure this product is the correct model and you have all the parts required for installation and using.
3. All the valves should be supplied with hot and cold water at balanced pressure. If not, then the mixing function will not work correctly.
4. Please flush the water system to ensure that no metal swarf, solder, and other impurities can enter the valves.
5. Turn off water supply before commencing work, this should be done at the isolating valves of inlet feeds if fitted or main stopcock.
6. Please read these instructions carefully and keep it for future reference.

- **Single-person assembly**
- **We always recommend using professional tradespeople to install your product**

V1_12.10.2023

1

WORKING PRESSURE AND TEMPERATURE

Maximum Static Pressure: 10 Bar

Flow Pressure, Hot & Cold: 0.5-10 Bar

Hot Supply Temperature: 55-65 °C

Cold Supply Temperature: 5-25 °C

FITTING YOUR NEW THERMOSTATIC VALVE

Fitting your new thermostatic valve is easy when you follow these step-by-step instructions.

1. Identify all components and check the dimension drawing.

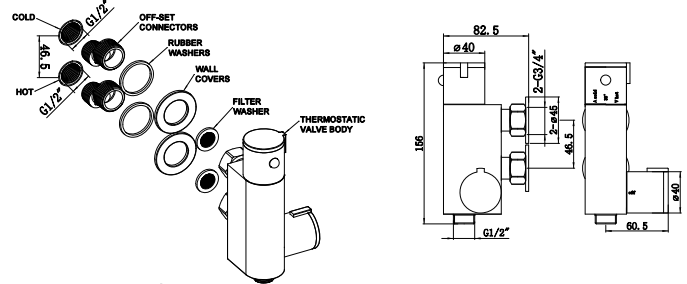

2. Prior to installation flush out pipework to remove debris.
3. Fit off-set connectors with sealant to the inlets in the wall properly.
4. Place rubber washers and wall covers on off-set connectors. Then fit filter washers and valve body to off-set connectors with spanner. Pls do not overtighten.
5. Turn on water supply to refill system and check for leaks. If any leaks are noticed, check that the connections are adequately tightened. Once the connections are satisfactory, you can then connect your shower kit.
6. Make sure the thermostatic valve is well installed, and in proper operation, then connect one end of hose to thermostatic valve.

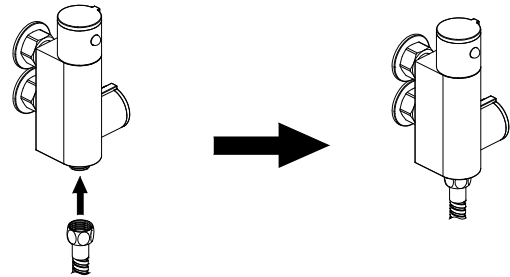

2

7. Drill hole properly on the wall, and insert the wall plug into the hole, fix the wall bracket with screws.

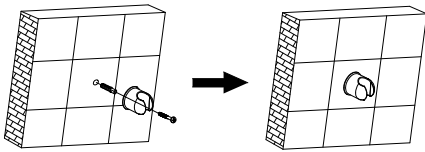

8. Connect another end of hose to spray, turn on the water supplies and check for correct operation.

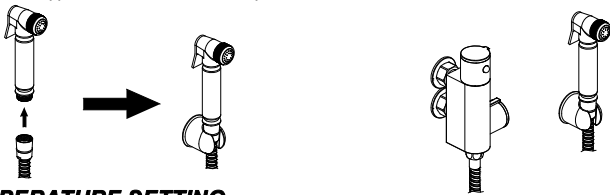

9. The installation is completed.

TEMPERATURE SETTING

The temperature control handles on this product are factory set and should require no adjustment.

However, if for any reason the handles and/or the cartridge is removed, it is important the following procedures are followed.

- 1) Quarter-turn the handle on the right anti-clockwise, the water will come out.
2) Allow the water temperature to stabilize around 3 minutes and check the temperature by thermometer.
3) Proceed if temperature is not 38°C.
- 1) Turn on the valve.
2) Temperature is up when valve stem is turned clockwise, temperature is down when valve stem is turned anti-clockwise.
3) When temperature is correctly set, fix the handle back to the valve as show above.
4) Tighten the screw, adjust the handle properly, then fix the cap to the handle.
- 1) Take off the cap.
2) Untighten the screw.
3) Get out the handle and washer.

MAINTENANCE (THERMOSTATIC CARTRIDGE)

* Water supply must be turned off before internal components are removed for maintenance.

* After a long time usage of thermostatic valve, there will be some waste or debris from

3

the water pipe on and around the thermostatic cartridge, which will affect the flow and sensitivity of automatical temperature adjustment. Please take out the thermostatic cartridge and clean the cartridge strainer

* To avoid damage, please remove all chrome parts before any maintenance takes place.

- 1) Take off the cap, untighten the screw, to get out handle and washer. The get out plastic block. (See Fig. 1)
- 2) Untighten the cartridge clamp nut to take out the cartridge. (See Fig. 2)
- 3) Wash the cartridge with clean running water, dry and lightly grease the seals (only use silicone grease).
- 4) Replace the cartridge and make sure it back to the primary position.

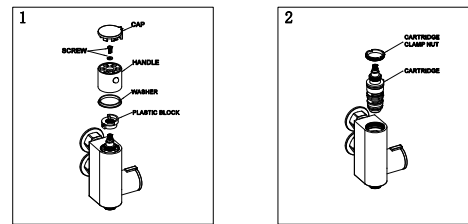

TROUBLE SHOOTING

1. Output water temperature does not correspond with temperature set
Cause: Thermostat has not been adjusted base on the existing home water system
Remedy: Adjust the thermostat, refer to "Temperature Setting" procedure.
Cause: Hot Water temperature too low.
Remedy: Adjuster the water heater, increase hot water temperature to 65 °C.
2. Very low flow or no flow
Cause: Supply pressure inadequate
Remedy: Check hot and cold feeds. If a pump has been installed, please check to see if the pump is working. (the valve will shut down if either the cold or hot water supply fails)
3. Water will not run hot enough when first installed
Cause: Wrong maximum temperature setting
Remedy: Adjust the maximum temperature, refer to "Temperature Setting" procedure.

CLEANING

We do NOT recommend you use any household cleaners to clean the product, because these cleaners change substance or formula too frequently. So product should be always cleaned only with soapy water and rinsing with clean water and drying with soft cloth.

For more information

• visit betterbathrooms.com

• email customerservices@buyitdirect.co.uk

• call 03303903062

• write to Trident Business Park, Neptune Way, Huddersfield, HD2 1UA

better
bathrooms

Part of the BuyItDirect Group

4